



LT-4100S GMDSS SATELLITE COMMUNICATIONS SYSTEM

IRIDIUM CERTUS® 100 MARITIME

designed and built for the demanding and rough environment at sea

IRIDIUM GMDSS

The LT-4100S GMDSS System is an Iridium satcom product supporting all GMDSS requirements for SOLAS vessels with 100% global coverage. The LT-4100S GMDSS System is fully compliant and tested towards the new GMDSS standard IEC 61097-16 (2019). The LT-4100S GMDSS System is MED / Wheelmark approved.

LT-4100S GMDSS IN SHORT

The LT-4100S GMDSS System is small and compact. No requirements for either message terminal or printer. The LT-4100S GMDSS System offers the Iridium GMDSS services, High quality Voice (2 channels), and IP Data. The built-in GNSS/GPS receiver supports tracking functionality and can output NMEA 0183 position data. The LT-4100S GMDSS System can interface to external BAM and ECDIS systems. The Antenna Unit can be installed up to 500 meters from the Control Unit.

- **100% global coverage**
- **Distress Alert & Distress Call**
- **Maritime Safety Information (MSI)**
- **BAM & ECDIS interface**
- **2 X Voice Channels (high-quality)**
- **IP-data: 22 kbps (up) / 88 kbps (down)**
- **IP-data management (configuration of outgoing firewall, port forwarding, etc.)**
- **Up to 500 m antenna cable**

PRODUCT DESCRIPTION



The standard LT-4100S GMDSS System is offered in a version that includes control unit & bracket mount, handset & cradle, antenna unit & power cable. The standard version fulfills all the GMDSS basic requirements. Additional services like SSAS, GMDSS Alarm Panels and printer, will require the LT-3140S Interface Unit.

INTERFACE UNIT

The LT-3140S Interface Unit supports:

- **3 x LT-3150S Alarm Panel**
- **1 x LT-3160S Printer Adapter**
- **3 x SSAS Alert button (coloured red)**
- **1 x SSAS Test button (coloured green)**
- **2 x RS-422 (BAM / MSI / GNSS)**
- **4 x Ethernet (LT-4110S CU, PC, future use)**



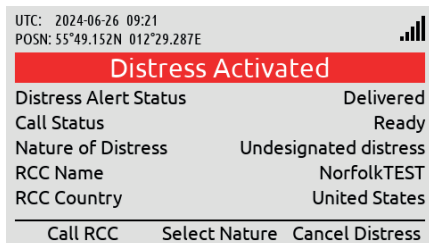
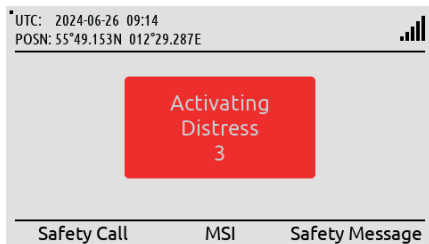
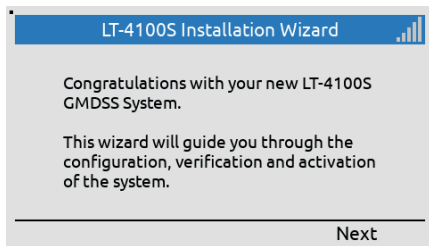

Installation Wizard

The installation and setup of the LT-4100S GMDSS system has been made user-friendly by adding an Installation Wizard that will guide you through the initial configuration and activation of the system on the Iridium GMDSS System (IGS).

Activating Distress

Distress Alert can be activated by pushing the DISTRESS button on the front of the control unit. A Distress Alert message will be sent to the Iridium GMDSS System (IGS) and immediately forwarded to the Rescue Coordination Center (RCC).

Distress Call

The LT-4100S GMDSS System is supporting both Safety Calling (priority) and General Calling (non-priority). The terminal can be configured to automatically setup a Safety Voice call (priority: Distress) to the RCC, if the DISTRESS button has been activated.

SYSTEM CONFIGURATION

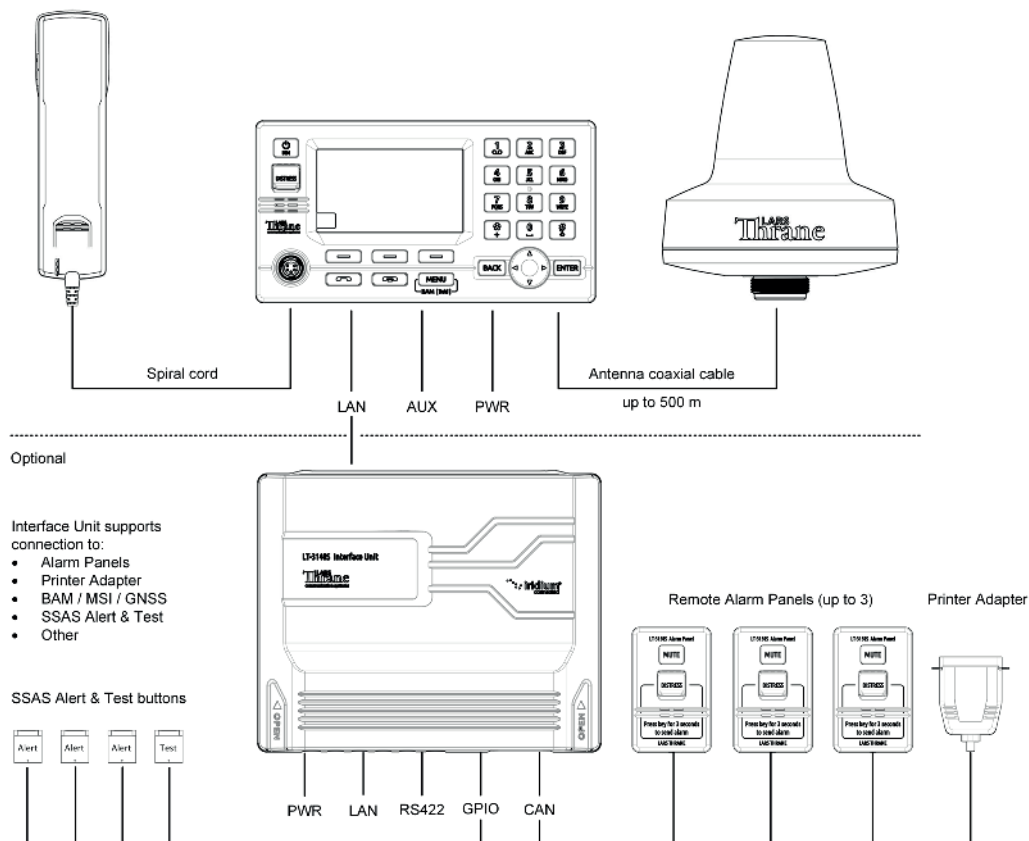

SPECIFICATIONS

LT-4100S GMDSS SATELLITE COMMUNICATIONS SYSTEM

Certification & standards	Maritime CE, FCC, ISED, RCM, RED, MED (Wheelmark), RoHS 2, Iridium®
Vibration, operational	IEC 60945
Vibration, shock	Half sine 20 g/11 ms
Compass Safe Distance, std.	0.3 - 1.4 m (1.0-4.6 ft)
Compass Safe Distance, steer.	0.3 - 0.9 m (1.0 - 3.0 ft)
Power consumption: operating mode, max	34 W
Power consumption: Idle	12 W
BAM EUT function types	P

LT-4110S Control Unit

Weight	0.67 kg (1.48 lbs)
Dimensions	224.0 x 120.0 x 70.0 mm (8.82 x 4.72 x 2.76 in)
Temperature, operational	-15°C to +55°C (+5°F to +131°F)
IP rating, dust and water	IP32
Interfaces	Ethernet, auxiliary, DC input, chassis ground Antenna Unit (N conn.), handset, SIM card
Input power	12-24 VDC (2.0-1.0 A)

LT-3120 Handset Unit

Weight (handset + wire)	0.30 kg (0.66 lbs)
Dimensions	52.8 x 208.8 x 38.2 mm (2.08 x 8.22 x 1.50 in)
Temperature, operational	-15°C to +55°C (+5°F to +131°F)
IP rating, dust and water	IP32

LT-4130 Antenna Unit

Weight	1.39 kg (3.05 lbs)
Dimensions	182 x Ø 162 mm (7.16 x Ø 6.39 in)
Temperature, operational	-40°C to +55°C (-40°F to +131°F)
IP rating, dust and water	IP67
Interfaces	Control Unit (N conn.)
Antenna communication cable	Coaxial cable, up to 500 m (1500 ft)

LT-3140S Interface Unit

Weight	0.71 kg (1.57 lbs)
Temperature, operational	-15°C to +55°C (+5°F to +131°F)
IP rating, dust and water	IP20
Interface	4 x Ethernet, 2 x RS-422, 4 x GPIO, 4 x CAN, DC input, chassis ground
Input Voltage	12-24 VDC (0.8-0.4 A)

LT-3150S Alarm Panel

Weight (incl. 25m cable)	0.07 kg (0.15 lbs) / 1.29 (2.84 lbs)
Temperature, operational	-15°C to +55°C (+5°F to +131°F)
IP rating, dust and water	IP30
Interface	CAN
Warranty	2 year
Maintenance	None

IN THE BOX

LT-4110S Control Unit	P/N: 51-104870
LT-3120 Handset	P/N: 51-100988
LT-3121 Cradle	P/N: 51-101181
LT-4130 Antenna Unit (Maritime)	P/N: 51-102365
Bracket Mount, Control Unit	P/N: 91-100771
Power Cable, 3m	P/N: 91-102118
User & Installation Manual	P/N: 95-104951

ACCESSORIES

Flush Mount, Control Unit	P/N: 91-100772
Pole Mount (1.5" pipe, 38.8mm), Antenna Unit	P/N: 91-100774
Pole Mount (2.0" pipe, 53.0mm), Antenna Unit	P/N: 91-102550
Auxiliary Cable, 3m	P/N: 91-100768
Coaxial Cable Ø10.3mm (up to 500m)	
Crimping Tool for Coaxial Cable Ø10.3mm	

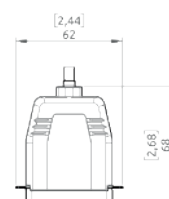
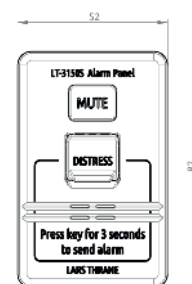
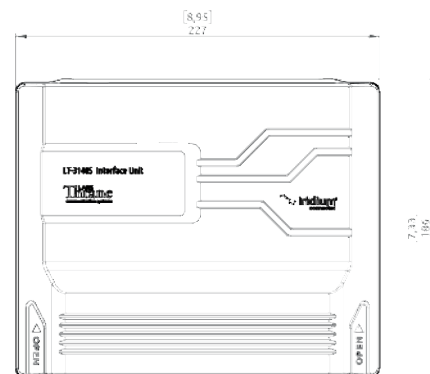
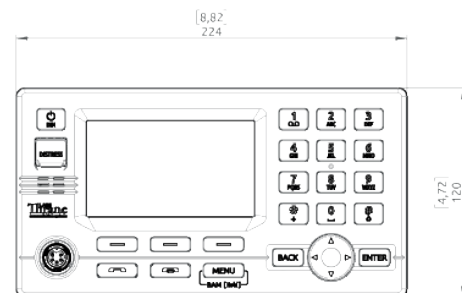
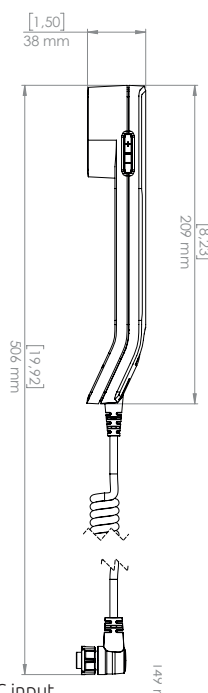
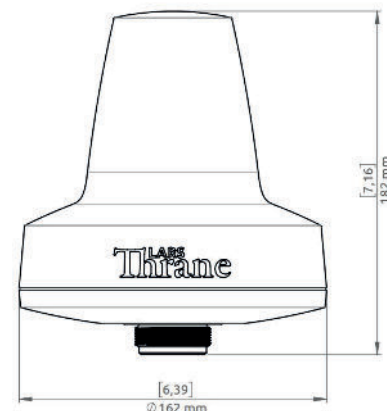

Lars Thrane A/S
Skovlytoften 33
DK-2840 Holte
Denmark

Phone: +45 88 30 10 00
Fax: +45 88 30 10 09
Email: sales@thrane.eu

CVR DK-36042443
www.thrane.eu